

# Freightliner Action Bulletin

FAB010

12/09/02

## Fontaine® 7000 Series Cast Fifth Wheels

The new 7000 Series fifth wheels offer all the benefits of the standard 6000 Series, but in a cast design rather than pressed steel. While pressed/formed steel is just as strong as cast, some customers prefer one over the other – and Fontaine offers the choice. These new models feature the patented No-Slack® II locking mechanism which is the only lock on the market that adjusts for fifth-wheel slack automatically. A patented safety trigger prevents dangerous high hitching. Now customers who prefer cast fifth wheels will no longer have to settle for less than the best locking technology. The 6000 series fifth wheel is designed for *standard* and *moderate* duty applications. The 7000 series can be used in standard and moderate duty applications as well as some *severe* duty applications. Refer to the Fontaine Application Guide or contact Fontaine for more information on selecting the correct fifth wheel for the application.

### Benefits

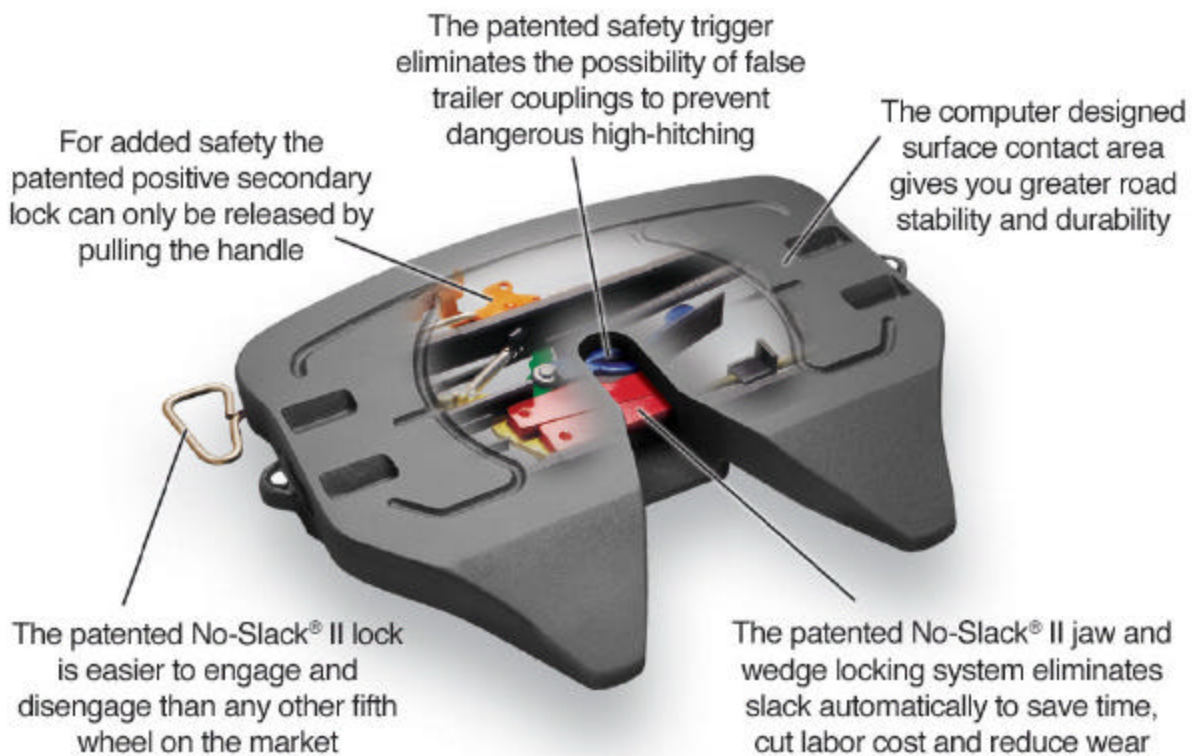

<b>Availability</b>	All Freightliner models
<b>Data Code</b>	See Data Book CD for specific code for application
<b>Further Information</b>	Fontaine International, Inc., Birmingham, AL <a href="http://www.fifthwheel.com">www.fifthwheel.com</a>